

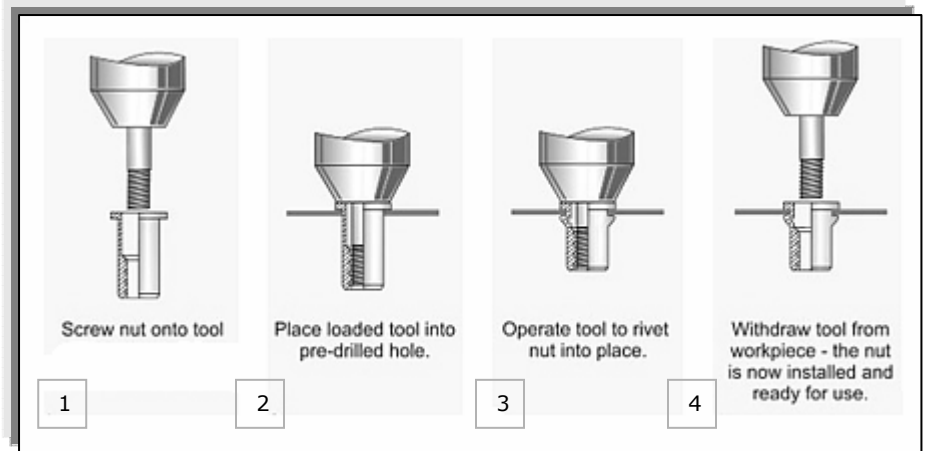

Cambridge *Engineering* Services Ltd

Tel 01767 699766 Fax 01767 692058

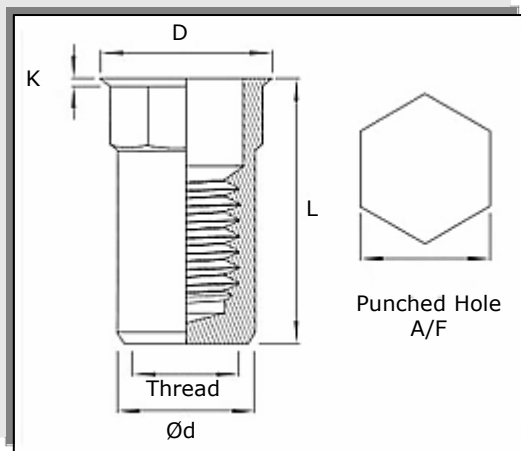

Data sheet for Metric Hexagon Rivet Nuts Closed End

Thread Pitch	Grip Range mm Min / Max	D +/- 0.20	K +/- 0.15	Ød +0.00 -0.15	Hole Size A/F +0.10 -0.00	L +/- 0.30
M3 x 0.5 *	0.50-1.10	5.80	0.30	5.00	5.00	11.70
	1.00-2.30					12.90
M4 x 0.7	0.50-1.30	6.80	0.30	6.00	6.00	15.10
	1.00-3.00					16.80
M5 x 0.8	0.50-1.50	8.00	0.40	7.00	7.00	16.80
	1.00-3.50					19.30
M6 x 1.0	0.50-1.50	10.00	0.40	9.00	9.00	21.30
	1.00-3.50					23.30
M8 x 1.25	0.50-1.80	12.00	0.40	11.00	11.00	24.00
	1.50-5.00					27.80
M10 x 1.50	0.50-3.20	14.40	0.50	13.00	13.00	32.00
	1.50-5.50					34.40

Finishes

Zinc / Yellow Chromate Passivation , Zinc Trivalent Chromate (RoHS compliant to order)

Material

Mild Steel

